

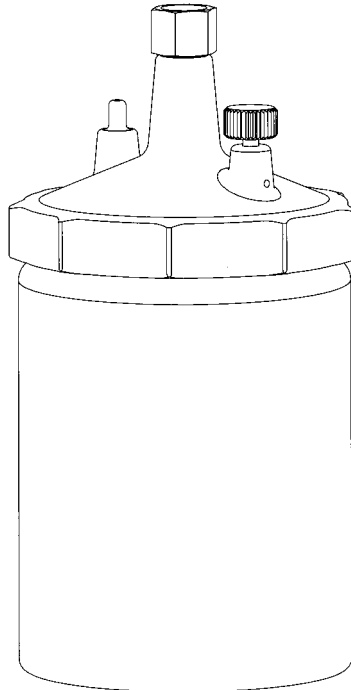

- 41-11 ½ Pint Cup Assembly
- 41-22 1 Quart Cup Assembly
- 41-32 Waterborne 1 Quart Cup Assembly
- 41-42 1 Quart Cup Assembly w/2 Pc Lid



These cups are pressurized for low-pressure high performance results with all Accuspray sprayguns.

Important: Read all instructions and warnings carefully before using this cup.

Literature #SC-FH-0804

Cup Warnings

1/2 Pint and 1 Quart Pressure Cup Do Not Exceed **10 psi**

Disconnect Atomizing Air Before Opening Cup

Open Pressure Relief Screw Before Opening Cup

Gun/Cup Installation

Thread the swivel nut of the cup lid onto the fluid inlet fitting of the spray gun. Tighten with an Accuspray Gun Wrench while applying counterforce with an 11/16" wrench on the fluid inlet fitting of the spray gun.

Before fully tightening, make certain that the fluid tube is pointed forward. Attach the pressure tube from the pressure stem on the gun head to the cup lid.

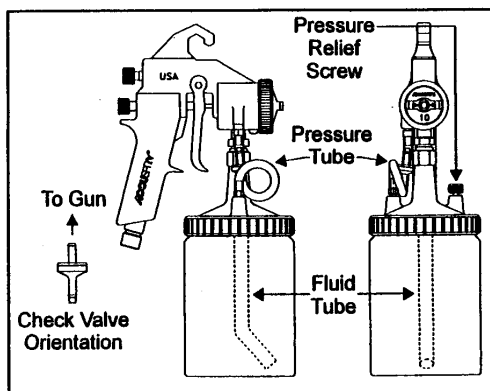

Note: Spray solvent through the gun before using it for the first time.

External Check Valve Assembly

To install the assembly, attach the short pressure tube hose from the check valve assembly to the gun. Loop the tube and attach it to the pressure stem of the cup. The loop plays an important role; it allows you to see any material that may be working its way back up the tube. A properly working check valve is required for uninterrupted spraying. The advantage of the external check valve is that in its remote location (away from the paint) it is not prone to becoming jammed. The external check valve is a wear part and it will require replacement after it becomes contaminated. The normal life expectancy is from one week to three months, depending on its care.

1/2 Pint Pressure Cup (41-11)

Item	P/N	Description
1	41-11	1/2 Pint Cup Assembly
2	94-101	1/2 Pint Cup Lid Assembly
3	94-082	1/2 Pint Fluid Cup
4	94-087	Cup lid Sub-Assembly
5	94-049/3	Check Valve Assembly(3 Pack)
6	91-129/4	Check Valve(Pack of 4)
7	94-035A	Pressure Relief Screw
8	94-084/4	Gasket(Pack of 4)

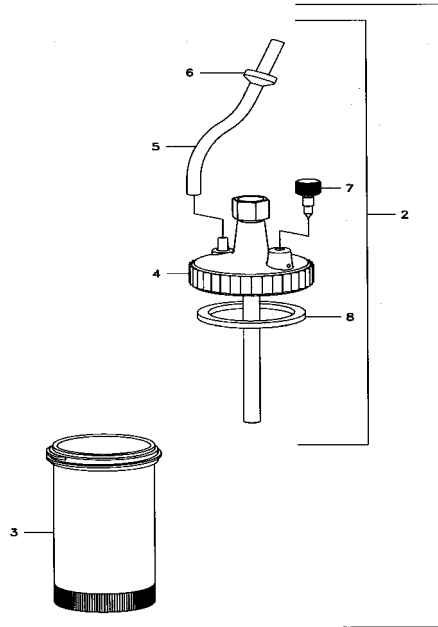

Also Available

- 94-231 Storage Cap Assembly**
- 94-232 Storage Cap Assembly**

Warning: Cup may leak or be damaged if spraying pressure exceeds 10 psi.

Maximum Cup Pressure: 10psi (.7 BAR)

1 Quart Pressure Cup (41-22)
 1 Quart Waterborne Cup (41-32)
 Teflon-coated aluminum cup with acetal lid.

<u>Item</u>	<u>P/N</u>	<u>Description</u>
1	41-22	1 Quart Cup Assembly
1*	41-32	Waterborne Cup Assembly
2	94-057	1 Quart Cup Lid Assembly
2*	94-237	Waterborne Lid Assembly
3	94-056	1 Quart Cup
4	94-061	Cup lid Sub-Assembly
4*	94-239	Waterborne Lid Sub-Assembly
5	94-049/3	Check Valve Assembly(3 Pack)
6	91-129/4	Check Valve(Pack of 4)
7	94-035A	Pressure Relief Screw
8	94-034/4	Gasket(Pack of 4)
9	94-021/3	Diaphragm (Pack of 3)
10	94-064/3	Spring Clip (Pack of 3)

* Parts for Waterborne Cup Assembly

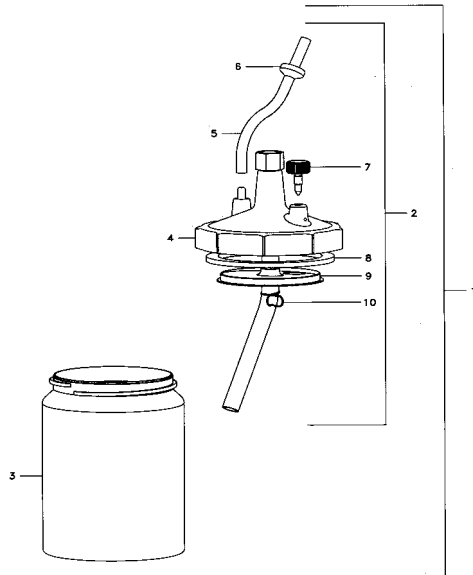

Also Available
94-233 Storage Cap Assembly
94-234 Storage Cap Assembly

Warning: Cup may leak or be damaged if spraying pressure exceeds 10 psi.

Maximum Cup Pressure: 10psi (.7 BAR)

1 Quart Pressure Cup (41-42)

Teflon-coated aluminum cup with acetal lid.

Item	P/N	Description
1	41-42	1 Quart Cup Assembly
2	94-596	1 Quart Cup Lid Assembly
3	94-594	1 Quart Fluid Cup
4	94-593	Cup lid Sub-Assembly
5	94-601	Check Valve Assembly
6	91-225	Serviceable Check Valve
7	94-597	Retaining Ring
8	94-035A	Pressure Relief Screw
9	UH-1377/3	O-Ring Gasket(Pack of 3)
10	94-021/3	Diaphragm (Pack of 3)
11	94-064/3	Spring Clip (Pack of 3)

Item 5 included in 94-596 cup lid assembly.

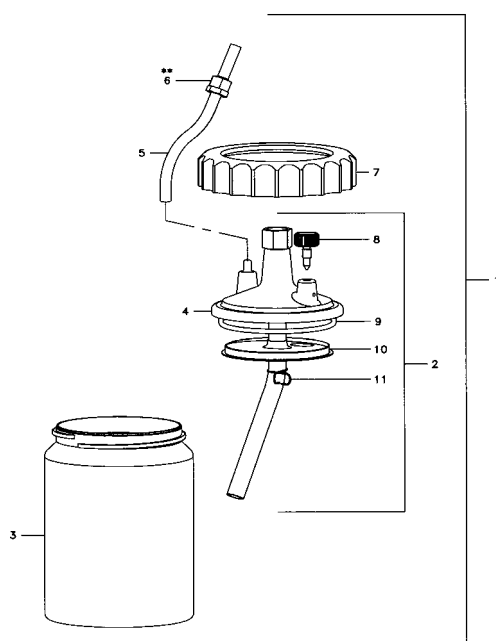

Check Valve Service Parts

91-228/10 Replacement Diaphragms
94-603 Tube Replacement (5 Sets)

Also Available

94-433 Storage Cap Assembly
94-433 Storage Cap Assembly

Warning: Cup may leak or be damaged if spraying pressure exceeds 10 psi.

Maximum Cup Pressure: 10psi (.7 BAR)

5

Cup Cleaning

It is important to clean your cup after every use.

First remove the check valve assembly from the cup lid. Do not attempt to clean the check valve assembly.

Before removing the cup lid from the cup, be sure to relieve the cup pressure through the relief valve.

Unscrew the cup lid and remove the remaining material from the cup.

The gun and cup lid may remain assembled if a gun washer is used.

Pull the diaphragm down approximately 1 inch from the lid before placing the entire assembly into the gun washer.

If not using a gun washer, unscrew the cup lid and remove the remaining material from the cup and then rinse with a suitable solvent.

Warning: Gun washers are designed for cleaning, not storage of spray equipment. The ½ Pint cup may swell if not promptly removed and dried.

Gasket Notes

These cups are pressure cups. The gasket must be in good condition. The lid must be firmly seated to the cup to prevent air and fluid leakage. Inspect the gasket, lube the gasket channel, and pay attention to the fit with each use. Replace the gasket when necessary.

To extend the life the gasket: Clean and dry gasket surface and store with cup when not using.

To replace gasket:

- 1) Pull out old gasket. Thoroughly clean surface inside lid.
- 2) Inspect and clean lid of cup for dried paint and burrs. Clean with solvent or ultra-fine steel wool.
- 3) Place three drops of gun lube on finger and lightly rub over gasket channel inside lid. Carefully install new gasket. Make sure that the gasket is seated flat.
- 4) Tighten lid securely onto cup. Wait a few minutes, then retighten. This will ensure positive positioning of gasket onto lid for optimum seal.

Troubleshooting

When spraying a horizontal surface, fluid may occasionally work itself into the tube. In order to reverse this flow, follow these instructions.

- Hold the gun upright.
- Open the pressure relief valve screw.
- Only pull the trigger enough for air to flow. This will pressurize the tube, pushing the paint back into the cup.
- When the tube is clear of fluid, re-close the pressure relief screw.
- If the tube has been coated, replace before your next use.

To order additional copies of this manual, call Accuspray Customer Service at 1-800-618-6860 or fax your request to (440) 498-9815. You may also request the manual on the web at www.accuspray.net. Request Literature Number: SC-FH-0804

LIMITED WARRANTY

Accuspray, (Accuspray Application Technologies, Inc.), warrants all equipment manufactured by and bearing its name to be free from defects in material and workmanship on the date of sale by an authorized Accuspray distributor to the original purchaser for use. As purchaser's sole remedy for breach of this warranty, Accuspray will, for a period of twelve months from the date of sale, repair or replace any part of the equipment proven defective.

Accuspray is a registered trademark of Accuspray Application Technologies, Inc.

All other products named in this publication are either trademarks or registered trademarks of their respective owners.

